

3" HYRDOFOIL MIXING ASSEMBLY

VFD
60-600 RPM
110V W/ 6' PLUG
(NOT TO SCALE)

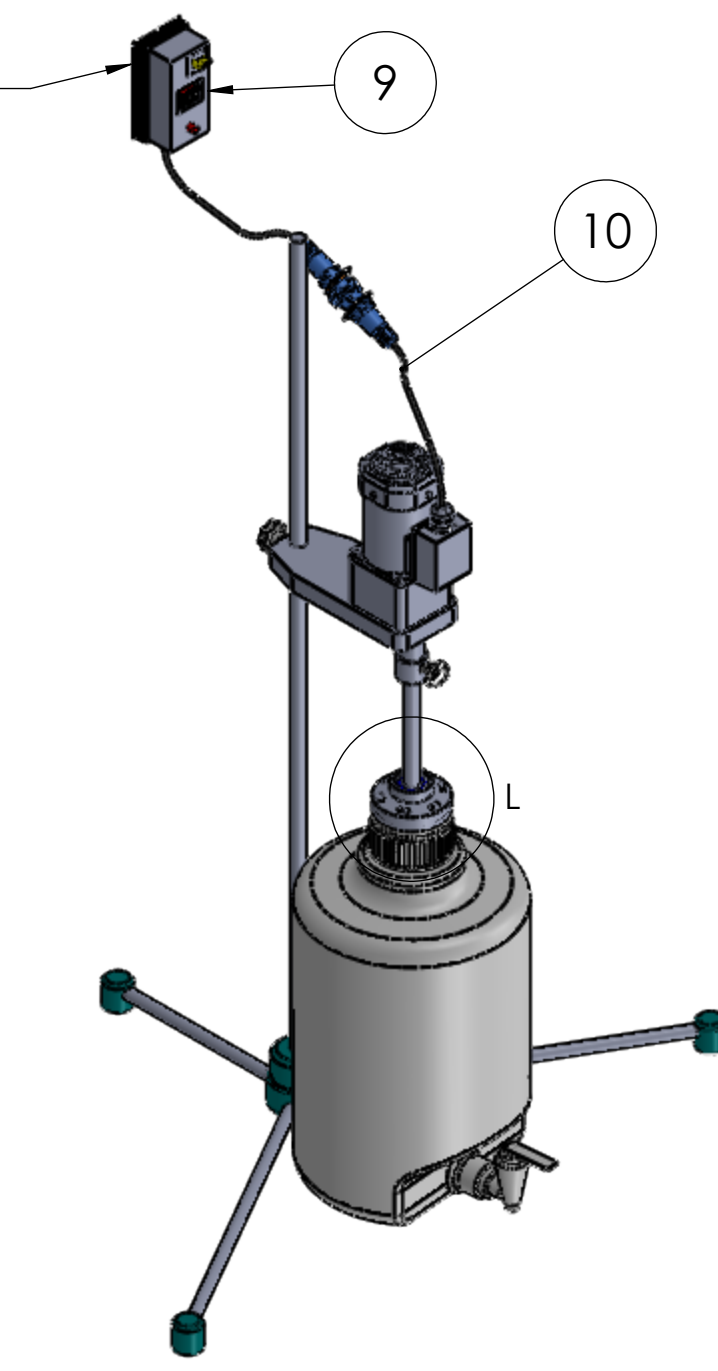

ITEM NO.	PART NUMBER	DESCRIPTION	Material	QTY.
1	VP-92311A533	1/4-20 X .250 CPSS	18-8 ST. ST.	2
2	VP-6092K47	5/16-18 KNOB	MIXED	1
3	MIXER STAND			1
4	90W GEAR MOTOR	90W MOTOR/ TEFC/ 230V/3PH	MIXED	1
5	SP1650	DRIVE COUPLING	316L ST. ST.	1
6	SP1751-90W-L	MOTOR BRACKET	ALUMINUM	1
7	VP-92384A036	QUICK RELEASE PIN	17-4 ST. ST.	1
8	SP1730-L	CARBOY IMPELLER	316L ST. ST.	1
9	AC TECH VFD	VARAIALE FREQUENCY DRIVE	MIXED	1
10	MELTRIC DSN20	ELECTRICAL CONNECTORS	MIXED	2
11	CARBOY CAP ASSEMBLY			1
11.1	SP1886	BEARING HOUSING	316L ST. ST.	1
11.2	SP1194	.750" LIP SEAL	USP CLASS VI RULON	1
11.3	VP-568-024	LIP SEAL O'RING	USP CLASS VI EPDM	1
11.4	SR12ZZ	BEARINGS	MIXED	1
11.5	VP-99461A530	0-42 X .500 PLASTITE FH	18-8 ST. ST.	12
11.6	VP-568-141	CARBOY O'RING	USP CLASS VI EPDM	1
11.7	VH-162-S02	BEARING RETAINING RING	302 ST. ST.	1
12	SP1899	3/4" SHAFT	316L ST. ST.	1
13	3 INCH WMP-PROP	3" WMP PROP	316L ST.ST.	1
14	92313A533	1/4-20 X .250 CPSS	316 ST. ST.	1

USP CLASS VI RULON DUAL LIP/LIP SEAL
USP CLASS VI EPDM O'RING

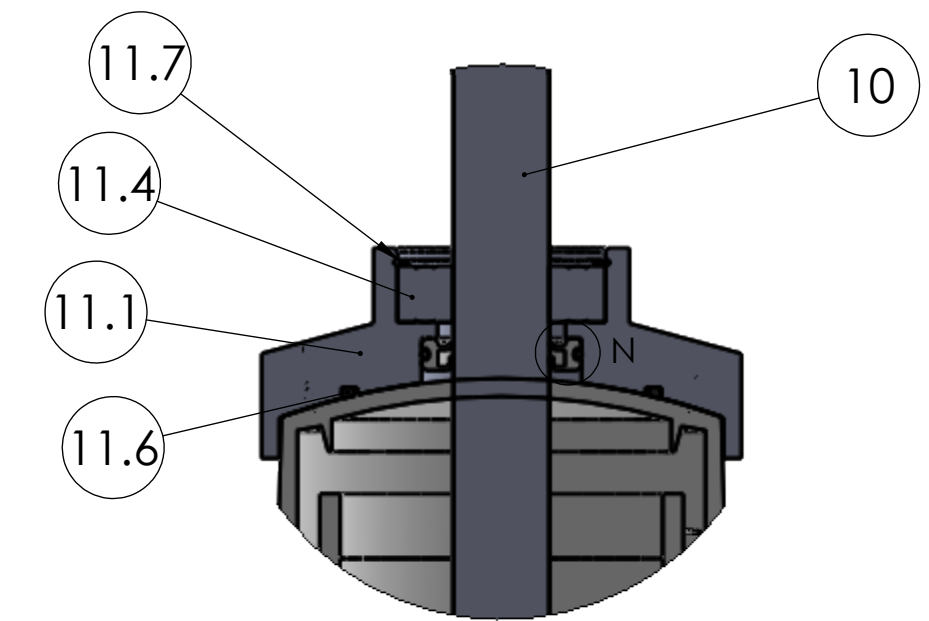
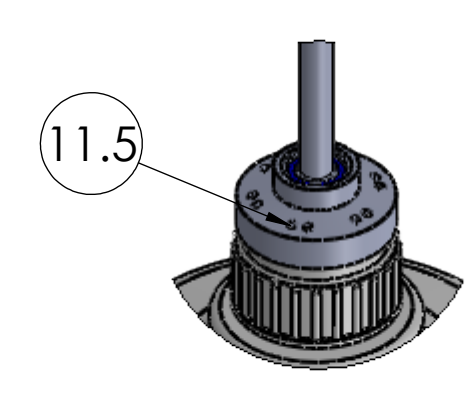
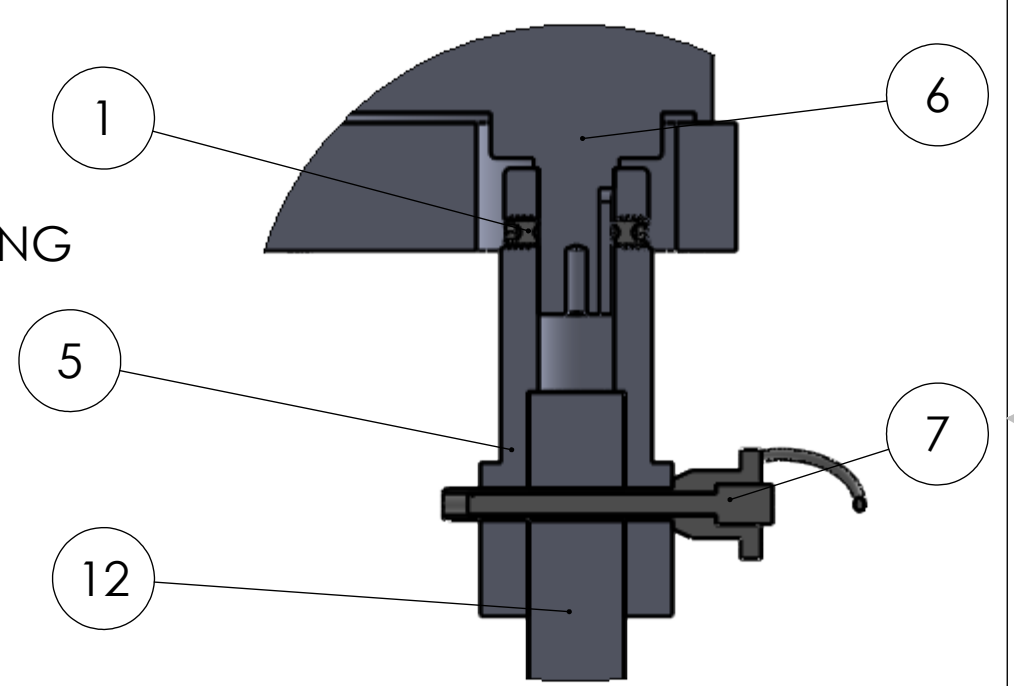
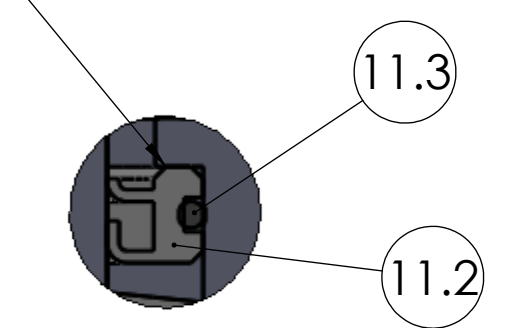

- NOTES:
1. PRE-WIRED WITH 110V 1PH PLUG
 2. 316LSS, 32RA FINISH C OF C FOR WETTED PARTS
 3. BRONZE DOCUMENT PACKAGE
 4. MIXER RUN TEST

WHITE MOUNTAIN PROCESS
MIXERS, AGITATORS & BLENDERS 800-737-9619
www.wmprocess.com sales@wmprocess.com

PROPRIETARY AND CONFIDENTIAL
THE INFORMATION CONTAINED IN THIS DRAWING IS THE SOLE PROPERTY OF <INSERT COMPANY NAME HERE>. ANY REPRODUCTION IN PART OR AS A WHOLE WITHOUT THE WRITTEN PERMISSION OF <INSERT COMPANY NAME HERE> IS PROHIBITED.

CUSTOMER:		DRAWN	NAME	DATE
LOCATION:		CHECKED	DVB	03/21/16
PRODUCT:		ENG APPR.		
TEMP:		MFG APPR.		
SPEED:	60-600 RPM	Q.A.		
SIZE:	3/4"	SERIAL #	16169	

WHITE MOUNTAIN PROCESS
WWW.WMPROCESS.COM

SIZE	DWG. NO.	REV
C	MA1235	A.1

SCALE: 1:2 WEIGHT: SHEET 1 OF 1